

**GENERAL LAND OFFICE**  
**PRIMER**  
**OF**  
**INSTRUCTIVE INFORMATION**  
**RELATIVE TO**  
**LEGAL SUBDIVISIONS AND PLATS**  
**OF**  
**PUBLIC LAND SURVEYS**

Prepared under direction of  
I.P. Berthrong  
Chief of Drafting Div.

T.O.W.

*Publication Printed circa 1921*

Reproduced by the U.S. Department of the Interior, Bureau of Land Management,  
Eastern States

# METHOD OF NUMBERING TOWNSHIPS.

*North and South from Base Line and East and West from Meridian.*

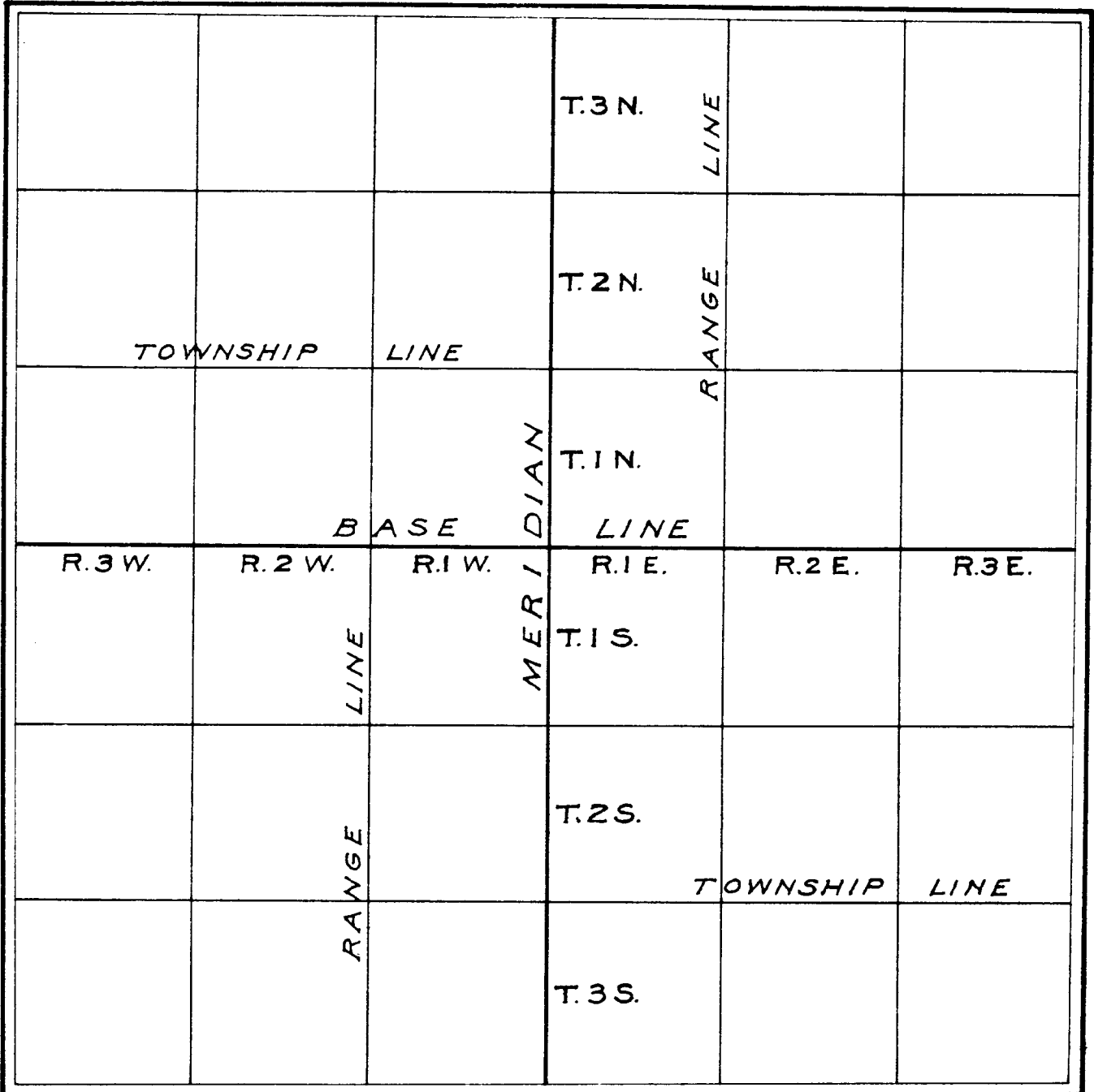

*THEORETICAL  
TOWNSHIP DIAGRAM  
SHOWING  
METHOD OF NUMBERING SECTIONS  
WITH ADJOINING SECTIONS*

36 <i>80 Ch.</i>	31	32	33	34	35	36	31 <i>80 Ch.</i>	
<i>6 Miles - 480 Chains</i>								
<i>1 Mile</i>							<i>80 Ch.</i>	
<i>1</i>	6	5	4	3	2	1	6	
<i>12</i>	7	8	9	10	11	12	7	
<i>13</i>	18	17	16	15	14	13	18	
<i>24</i>	19	20	21	22	23	24	19	
<i>25</i>	30	29	28	27	26	25	30	
<i>36</i>	31	32	33	34	35	36	31	
<i>1</i>	6	5	4	3	2	1	6	

# LEGAL SUBDIVISIONS OF SECTION

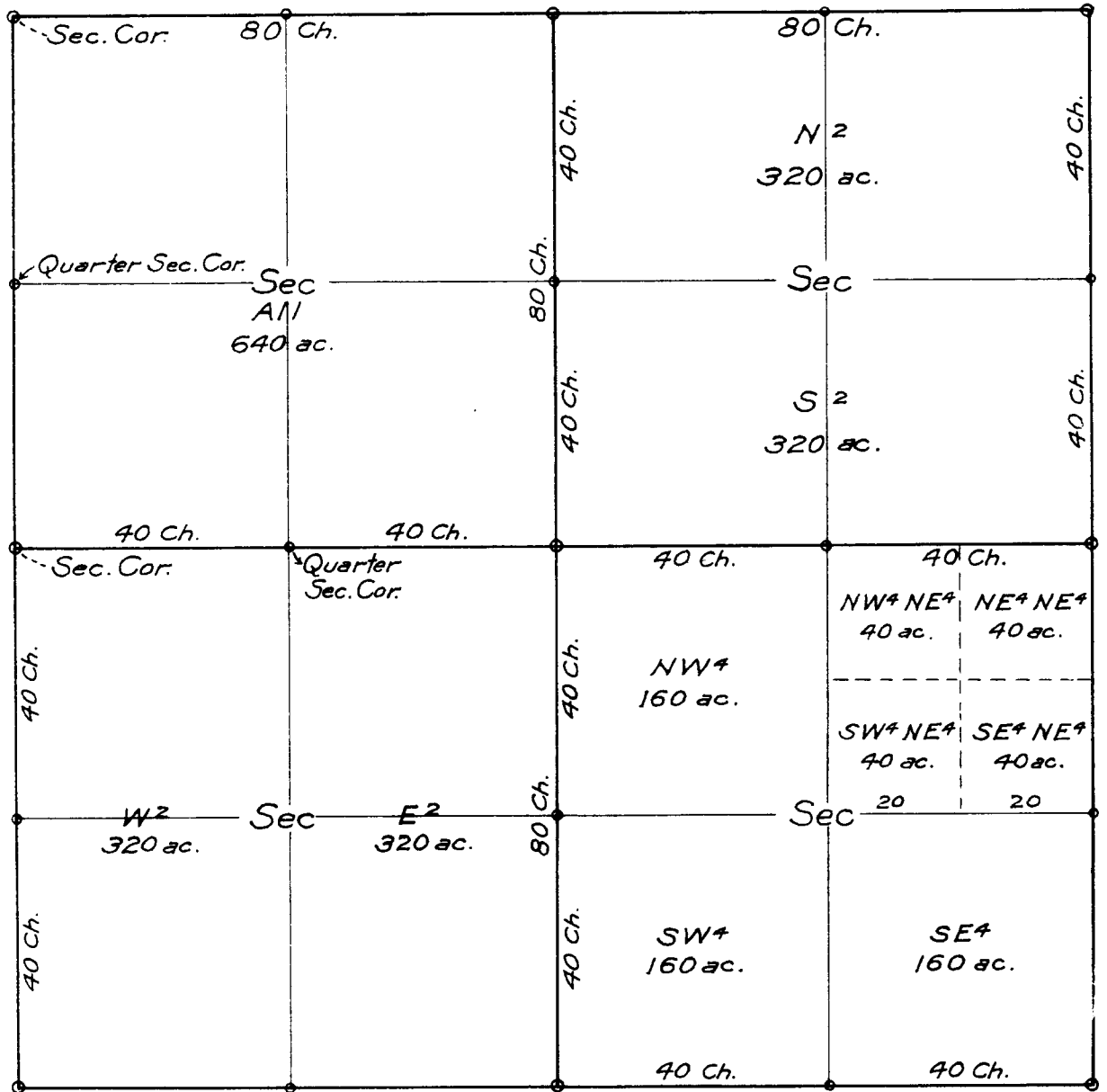

# SECTION DIAGRAM SHOWING SMALL SUBDIVISIONS

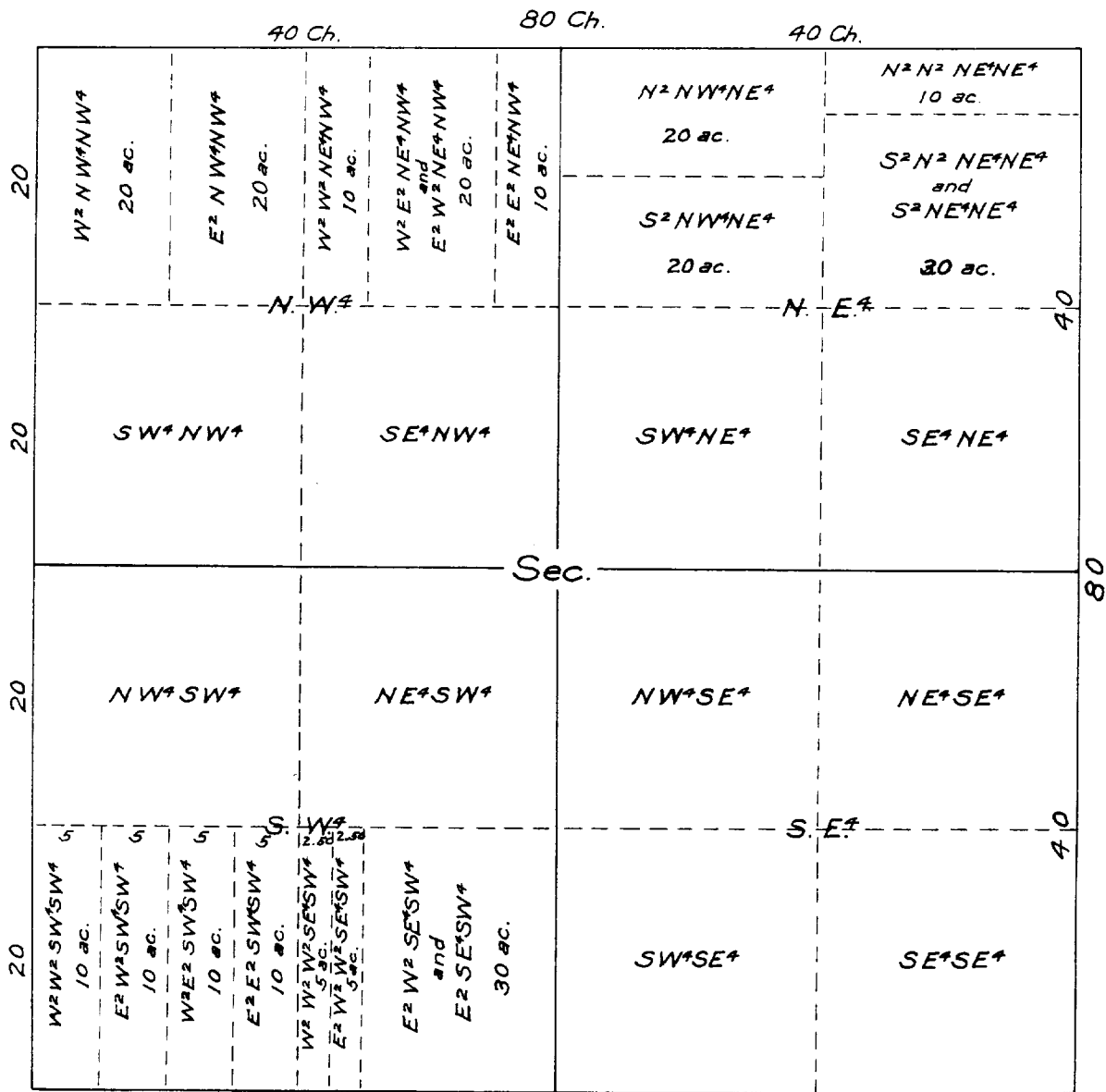



# UNITS OF MEASURE

---

## UNITS OF LINEAR MEASURE

1 Mile equals 5280 feet

1 " " 80 chains

1 Chain " 100 links

1 " " 66 feet

1 Link " 7.92 inches

1 Rod, Pole or  
Perch equals  $16\frac{1}{2}$  feet

---

## UNITS OF AREA

1 Acre equals 10 sq. chains

1 " " 43560 " feet

1 Sq. Mile equals 640 acres

---

A theoretical Township is six miles square, containing thirty six sections, one mile square, of 640 acres each.

Area of a theoretical township  
23040 acres.

DIAGRAM  
SHOWING  
USE OF PROTRACTOR

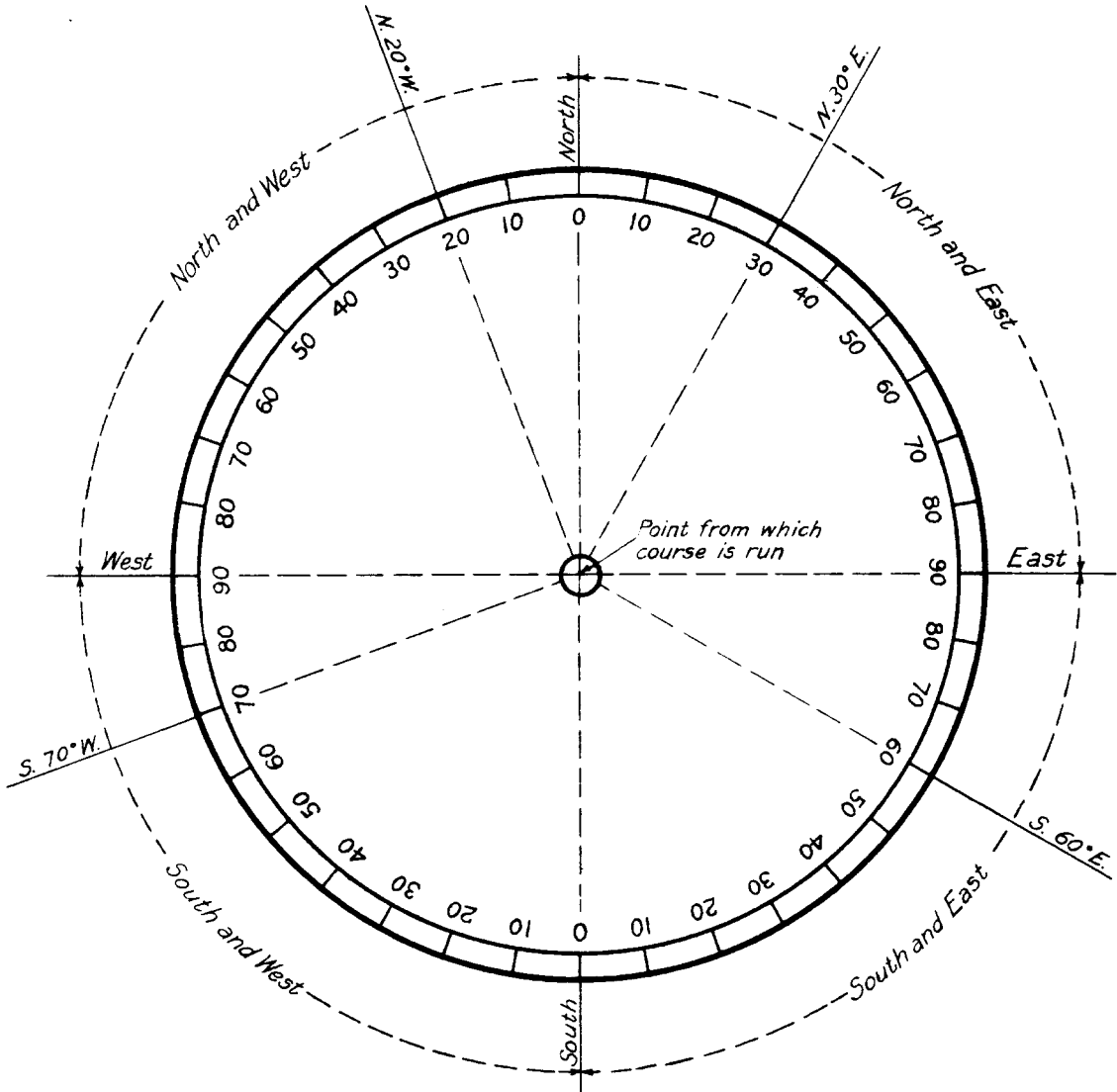



FOR CAREFUL CONSIDERATION AND OBSERVANCE.

---

The following must be observed in examining the records in the Drafting Division.

First, examine the card index for township plats and diagrams, so that you may be sure that the plat necessary for your case is in the files; it is possible that the plat desired has been withdrawn.

In withdrawing a plat or plat book, leave a receipt card for same, giving the township and range number or the number of volume, the number of your room, the date withdrawn, and sign your name.

Plats must not be retained for a longer period than is absolutely necessary for their use.

In returning plats to the files, it is absolutely necessary that the same be returned to their proper place—loose plats are filed in order, first by range number and then by township number.

Use the greatest care in handling of records—do not fold the plats; in many cases it would be impossible to restore or replace a plat if damaged, destroyed, or lost.

Do not make any notations on face of plat.

William Spry

Commissioner.